

## LUPNG News Line

Volume 2, October 2008

QuickTime™ and a  
TIFF (Uncompressed) decompressor  
are needed to see this picture.

### *Advanced Degree Program Moves Forward*

The Lutheran University of Papua New Guinea is committed to the development of a well-planned and quality institution that will be involved in teaching, researching and serving the people of Papua New Guinea.



Professor Dr. Ian Goulter, Vice-Chancellor and President of Charles Sturt University sign an agreement with Mr. Rimbink Pato (OBE) Chairman of LUPNG Establishment Committee.

Representatives of the Lutheran University of Papua New Guinea signed an agreement with Charles Stuart University NSW, Australia on September 1<sup>st</sup> this year, to offer a master's degree program in Primary Education to twenty-three Balob Teachers College Lecturers. This program involves both online and residential coursework provided by visiting Charles Sturt University professors.



Dr. Steven Pickford and Dr. Joan Phillip from Charles Sturt University

Charles Sturt University Professors, Dr. Steven Pickford and Dr. Joan Phillip have conducted a two-week intensive course on "Understanding Educational Research" at Balob from October 6<sup>th</sup>-17<sup>th</sup>. Two courses "Designing Learning Environments" and "Professional Portfolio" will be offered at Balob in early January 2009.



Twenty-three lecturers from Balob teachers college selected to receive an advance degree sponsored by LUPNG.

The degree will include studies in early childhood education. The lecturers that were selected for these studies required a recommendation from their supervisors, were required to pass an entrance exam and to sign a commitment to lecture at LUPNG for five years. The University is also exploring the possibilities of contracting an Australian University to offer a doctoral program to Lutheran theologians lecturing at Martin Luther Seminary.

---

## ***Australian Conference on Lutheran Education***

Representatives of the Lutheran University attended the recent ACLE International Pre-Conference meeting in Melbourne, Australia in September of this year.

Chairman of the Establishment Committee, Mr. Rimbink Pato and Dr. Lee Schluckebier attended the ACLE International Pre-conference meeting on September 30<sup>th</sup>. A variety of International Lutheran Educational Institutions were represented including representatives from Indonesia, Hong Kong, China, United States, as well as Papua New Guinea. Dr. Adrienne Jericho's presentation entitled "Contribution of Lutheran Educational Institutions to Global Citizenship" provided the background for the day's presentations and discussions.

One highlight of the conference was a presentation by Rev. Dr. Mitri Raheb, pastor of the Evangelical Christmas Church in Bethlehem. Due to political and legal issues Dr. Raheb was unable to be at the conference in person. His presentation was received via satellite and then presented to the conference. His presentation centered on Lutheran Heritage and the Christian school's responsibility in a global society. Conferences like ACLE provide various opportunities to present the story of the Lutheran University of Papua New Guinea to a variety of individuals of varying backgrounds. Such conferences also begin to prepare the University in its goal to meet international academic standards.

## ***Master Plan Studies Martin Luther and Balob Sites***

The Lutheran University is currently working with Infratech Management Consultants to develop a Master Plan to guide the current and future infrastructure of the University. The Master Plan development is ahead of schedule and the University hopes to be able to share the completed plans within the next month.



The site of Martin Luther Seminary has been the selected property that is proposed to house most functions of the Lutheran University of Papua New Guinea.

The sites of Martin Luther Seminary and Balob Teacher's College are being studied as to how the properties can be best used to develop the new Lutheran University. A proposed placement of new infrastructure follows on page 4 .



The site of Balob Teachers College has been the selected property that is proposed to house auxiliary functions of the Lutheran University of Papua New Guinea.

## ***Curriculum Development***

The Lutheran University is developing a four-year Primary Education Degree specializing in Early Childhood Education and English proficiency. The curriculum development project is moving forward preparing for the first courses to be presented in 2010. The Balob Teacher College lecturers have signed contracts to write the Bachelor of Primary Education curriculum. The writing has begun and the first draft is due the second week in January 2009. Once the first draft is received it will be reviewed and edited by the Lutheran University Project Office. The project will be completed by the middle of 2009. This curriculum-writing project is being conducted under the leadership of Mr. Peter Seth.

Presently the theology curriculum for Martin Luther Seminary is being reviewed by the Australian Lutheran College. When this review is completed, the curriculum will be finalized by the Martin Luther Seminary curriculum committee.

The Lutheran University is developing an After Degree in Secondary Education (two-year program) with an emphasis on Literacy and the Fine Arts.

Agribusiness courses are being considered to better assist graduates to serve the local needs of farmers in the village. Consideration in this program will be given to carbon-credit economy, biodiversity, and renewable resources including Agriculture, Fisheries and Forestry.

Finally, The Lutheran University will be developing a four-year Nursing degree that will specialize in Rural Health Services that are desperately needed to support the churches medical out posts. Issues important to grassroots and rural health concerns such as HIV, tuberculosis and malaria will be centre to the curriculum.

---

## ***Expatriate Lecturers Needed***

The Lutheran University is seeking specialized visiting or resident expatriate lecturers in the areas of English Language, Literacy, Early Childhood Education, and Theology. Overseas lecturers will need to be committed to pioneering the startup of a New Lutheran University and ensuring that international standards are met at the University's inception. Please contact LUPNG by sending a letter of intent and Curriculum Vitae with supporting documents.

## ***Vice Chancellor Search***

The Lutheran University is seeking an interim or full time Vice Chancellor with specific project management and university development skills. The University is searching for an individual with experience in university administration or who has been a part of the start-up of an educational institution. The candidate should have experience with the development of administrative and academic structures and planning for a new University. Experience with fundraising, tendering and overseeing new construction is preferred. Please contact LUPNG by sending a letter of intent and Curriculum Vitae with supporting documents. Alternatively, written nominations will be accepted.

## ***Establishment Committee Reaffirmed by the LUPNG Partners***

The Partners of the Lutheran University Project met in Port Moresby on the 22<sup>nd</sup> of October 2008 and reaffirmed the leadership and work of the LUPNG Establishment Committee. The Partners are the Morobe Provincial Government [MPG], the Evangelical Lutheran Church of Papua New Guinea [ELC-PNG], and the Gutnius Lutheran Church of Papua New Guinea [GLC-PNG].

Representatives of these Partners, Governor Luther Wenge [MPG], Head Bishop Rev Zao Rapa [ELC-PNG] and Head Bishop Rev David Piso [GLC-PNG] fully discussed a number of issues raised by the ELC-PNG.

Mr. Rimbink Pato, the Establishment Committee Chairman; Mr Patilious Gamato, the Acting Administrator of the MPG; and Mr. Isaac Teo, the General Secretary to the ELC-PNG, thoroughly briefed the partner representatives on the project's development.

The Partner representatives expressed complete and deep satisfaction with the programme of work undertaken by the Establishment Committee. They resolved however that a change in ELC-PNG's representation on the Establishment Committee should be allowed. They also fully agreed that Mr. Pato's leadership of the Committee should continue in order to provide continuity until the *LUPNG Act No. 12 of*

2006 is proclaimed by the Minister for Higher Education. Mr. Pato's leadership would make certain the programmes developed by the Committee would be fully implemented. The Partners were advised that the Committee had worked within the framework of an agreement they signed on 1<sup>st</sup> November 2006 regarding the funding and other aspects of the Project. The Partners considering how the partnership has worked, decided they must now give renewed approval to the actions taken by the Committee including legal and financial commitments made by it which was needed to establish the Lutheran University for the young men and women of this nation.

The Partners finally determined that a further agreement would need to be signed concerning continued ownership of the land by ELC-PNG and the division of assets developed and yet to be developed on it by relevant stakeholders.

## ***Seminary Plans***

Existing Seminary buildings will be used as much as possible. The designs and plans of the seminary take into account the need for some autonomy related to seminary functions. The new Seminary will be positioned close to the existing seminary and will be staged in its inception. It will use the existing Eckermann Chapel as a gateway to the new precinct. The Seminary precinct has a series of ponds lined with trees within a more open and formal layout, creating a serene atmosphere conducive to creating balance and harmony and a reflective place for prayer.

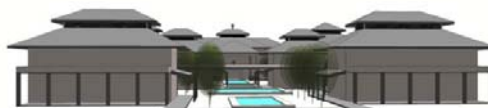

Architectural schematic of new Seminary buildings  
(Peddle Thorp Architects and Infratech Management Consultants)

The new Seminary building has been planned with reference to the layouts of traditional churches around the world. The buildings are laid out in crucifix form.

## ***Master Plan Concepts and Further Explanations***

The main objective of the master plan is to build a unique campus that meets international university standards. It is also proposed that there will be one central campus with all teaching, sporting and recreational spaces located on the larger Martin Luther Seminary site (south of the Busu road).

Accommodation and agriculture and main car parking will be located on the northern side of the road on this site, apart from MLS students who will reside near the seminary.

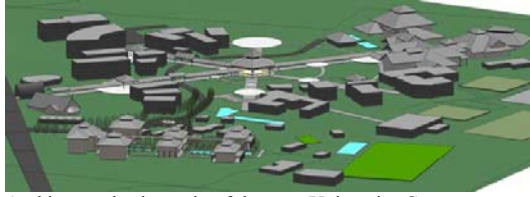

Architectural schematic of the new University Campus

Existing buildings on both sites will be retained for as long as possible until funding for further stages becomes available.

The University is been planned around a large central green garden area with a Central Forum Pavilion with buildings surrounding and reinforcing a central, unifying theme. The forum could be used for large gatherings of 500 or more people.

Twelve circular individually landscaped focal points will be located on these arms symbolizing the twelve apostles that surround Jesus. The circular centres spiral out in position and size from the central core, symbolizing the expansion and goodwill of Jesus' word radiating through the campus and world.

Most Sports areas will be located on the Martin Luther site and will be kept to the lowest and flattest area to the south of the site where they are currently located.

Water and ponds will also be used throughout the University to act as parts of the storm-water system or to act as uplifting visual and noise backgrounds to spaces with the use of fountains.



Proposed plans show dormitories and residential areas on the north side of Busu Road and offices, lecture halls, and sports fields on the south side of Busu Road on the Martin Luther Seminary Site. Further revised plans are expect by mid November. (Peddle Thorp Architects and Infratech Management Consultants)

P.O. Box 1513  
Lae, Morobe Province  
Papua New Guinea

Phone: 675-472-8432 Fax: 675-472-8452  
Email: [lupng@datec.net.pg](mailto:lupng@datec.net.pg)  
Web Site: [www.lupng.org](http://www.lupng.org)

*Teaching, Researching, and Preparing Students for Service*